

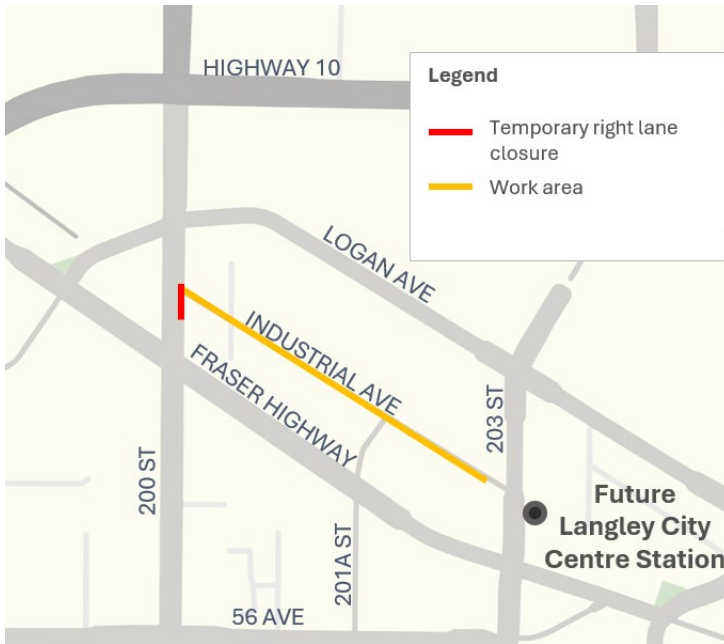

Construction Update: Pile driving on Industrial Avenue



Map: Industrial Avenue between 200 Street and 203 Street.

Mitigations such as noise shrouds around pile driving equipment and noise blankets on fencing will be in place where possible.

More information on the following page.

Construction of the Surrey Langley SkyTrain is underway; construction of the elevated guideway is beginning on Industrial Avenue between 200 Street and 203 Street.

Pile driving for column foundations will begin May 14, 2026, and is expected to continue through early 2027. Crews will start at 200 Street and work east. Please be aware of the following:

- Mobilization to the area is underway. Crane mats, office trailers, fencing and crew parking will be placed in the project area on Industrial Avenue.
- Pile driving activities can increase noise and cause vibrations.
- To advance work in this area, intermittent overnight welding activities will occur. These activities are not expected to increase noise.
- Access for pedestrians and cyclists is located on the north side of Industrial Avenue.
- Eastbound traffic only will continue on Industrial Avenue from 200 Street to 203 Street.
- Temporary right lane closure northbound 200 Street at Industrial Avenue from mid-May, for approximately one month.
- Business access will be maintained. Our team will be in contact with businesses to discuss access as work progresses.

Contact

Website: surreylangleyskytrain.gov.bc.ca

Email: surreylangleyskytrain@gov.bc.ca

24/7 Information Line: 1-844-815-6111

Thank you for your cooperation and understanding.

ਜ਼ਰੂਰੀ ਜਾਣਕਾਰੀ: ਕਿਰਪਾ ਕਰਕੇ ਇਸਦਾ ਅਨੁਵਾਦ ਕਰਵਾਓ
ज़रूरी जानकारी: कृपया इसका अनुवाद करवाएं
MAHALAGANG IMPORMASYON: Mangyaring isalin ito
重要資訊: 請找人為你翻譯
중요정보: 번역해주세요



What to Expect



Timing

Mid-May 2026, until early 2027.



Hours of Work

Construction hours: 7 a.m. to 10 p.m. Monday to Saturday. Welding activities may occur overnight, as well as on Sundays and Statutory Holidays.



Traffic

Eastbound only traffic on Industrial Avenue. Right lane closure northbound 200 Street near Industrial Avenue mid-May 2026 for up to one month.



Impacts/Interruptions

Intermittent noise and vibrations. You may notice things like water in glasses moving or light fixtures swaying. Vibrations are assessed prior to construction and monitored at active work areas to ensure building structures are not affected.

Contact

Website: surreylangleyskytrain.gov.bc.ca

Email: surreylangleyskytrain@gov.bc.ca

24/7 Information Line: 1-844-815-6111

Thank you for your cooperation and understanding.

ਜ਼ਰੂਰੀ ਜਾਣਕਾਰੀ: ਕਿਰਪਾ ਕਰਕੇ ਇਸਦਾ ਅਨੁਵਾਦ ਕਰਵਾਓ

ज़रूरी जानकारी: कृपया इसका अनुवाद करवाएं

MAHALAGANG IMPORMASYON: Mangyaring isalin ito

重要資訊: 請找人為你翻譯

중요정보: 번역해주세요